

Adding your IMAP Mail Account on your iPhone

1. Tap the settings icon on your home screen



2. What you see on your next screen depends on your phone's Operating System.

Select either "Accounts & Passwords" / "Mail" or "Mail, Contacts, Calendars" as seen in the three separate screenshots below

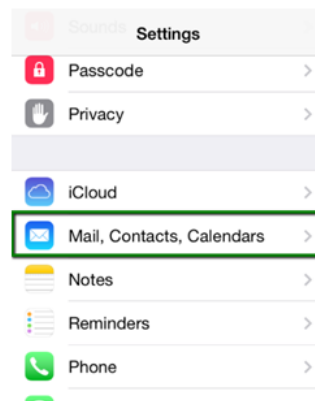
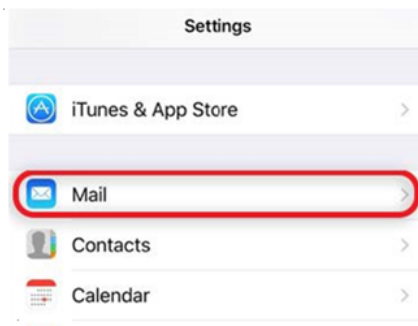

3. Select Accounts

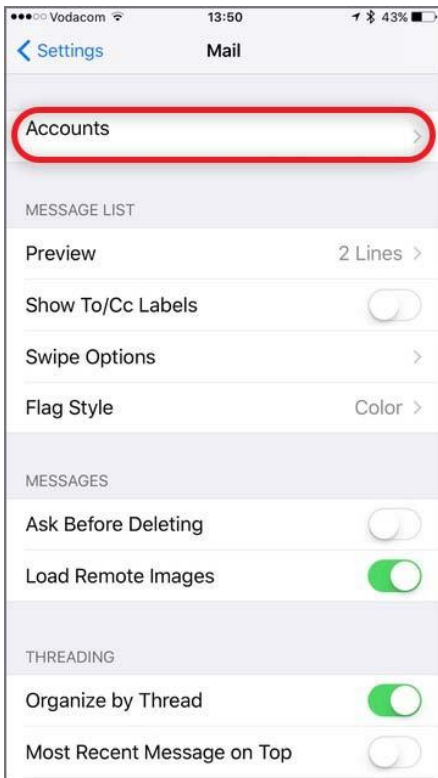

4. Select Add Account...



5. Select **Other** from the menu

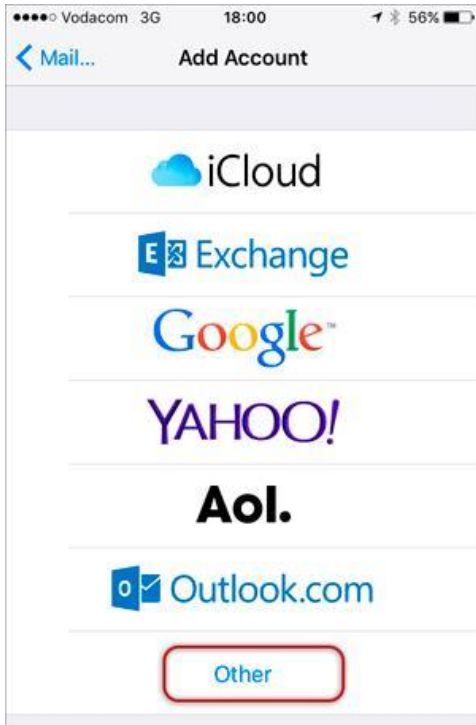

6. Select **Add Mail Account**



Enter your account information

7. Enter your Name, Full Email & Password > **Next**

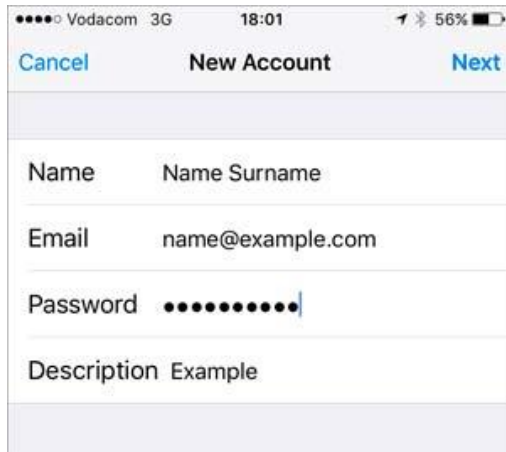

A screenshot of a mobile application's 'New Account' screen. The status bar at the top shows 'Vodacom 3G', the time '18:01', and a battery level of '56%'. The screen has a title bar with 'Cancel' on the left, 'New Account' in the center, and 'Next' on the right. Below the title bar are four input fields: 'Name' with a sub-label 'Name Surname', 'Email' containing 'name@example.com', 'Password' with a masked password of ten dots, and 'Description' containing 'Example'.

Configure Incoming and Outgoing Servers

8. Select **IMAP**

9. Scroll down to **Incoming Mail Server** and enter all the relevant details, then do the same for **Outgoing Mail Server**, as in the screen below and then select **Next**. • Ensure that **User Name** is the **full** email address
• **User Name & Password** are the same for both **Incoming & Outgoing** servers



A screenshot of the 'New Account' screen at a later stage. The status bar shows 'Vodacom 3G', the time '18:04', and a battery level of '56%'. The title bar remains the same. Below the title bar, there are two radio buttons for selecting the mail protocol: 'IMAP' (which is selected and highlighted with a red box) and 'POP'. Below these are the same input fields for Name, Email, Password, and Description as in the previous screenshot. The screen is divided into two sections for server configuration. The 'INCOMING MAIL SERVER' section has fields for 'Host Name' (mail.example.com), 'User Name' (name@example.com), and 'Password' (masked). The 'OUTGOING MAIL SERVER' section has fields for 'Host Name' (smtp.example.com), 'User Name' (name@example.com), and 'Password' (masked).

Verify Server Identity

10. You may receive a prompt asking you to verify the incoming and outgoing servers – you can click **Continue** for each.



11. Save



12. Choose the **new account** that you've just created



then

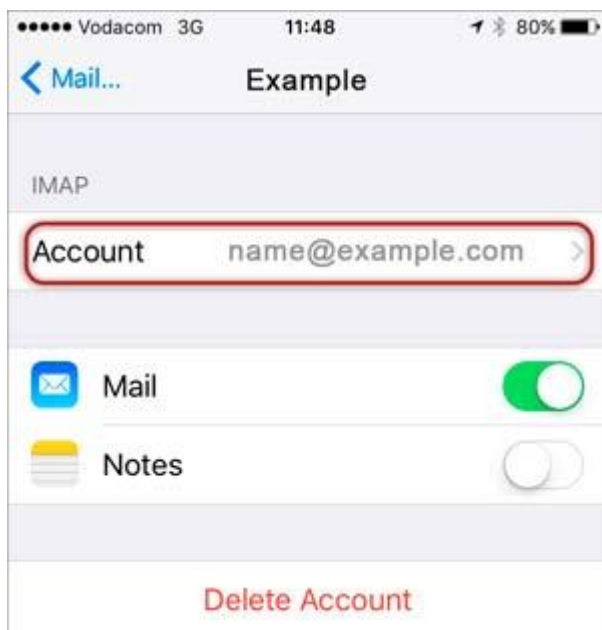

13. Choose the **SMTP server** (see screenshot)



Then tap on the **Primary Server** as seen below...



14. Check and confirm these SMTP settings:

User Name is the *full* email address

“Use SSL” MUST be set to **“OFF”** (The slider should be White and *not* Green)

Authentication must be set to **Password**

Server Port must be **587**

Tap > **Done**



••••• Vodacom 3G 10:55 83%

Cancel smtp.example.com Done

Server

OUTGOING MAIL SERVER

Host Name smtp.example.com

User Name name@example.com

Password ••••••••••

Use SSL

Authentication Password >

Server Port 587